

HIGH CURRENT POWER INDUCTOR

FAPQ2918 SERIES

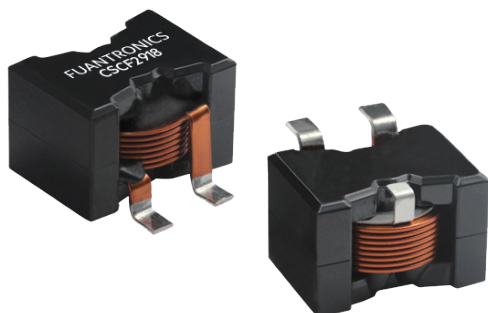

ELECTRICAL SPECIFICATION

- Assemblage design, sturdy structure
- High current, low magnetic loss, low ESR, small parasitic capacitance
- Flat wire winding, achieve a low DCR. Temperature rise current and saturation current is less influenced by environment
- Operating Temperature Range: -40°C to +125°C. (Including coilis temperature rise)
- All Parts Meet Rohs Compliance.
- Weight: App. 30.0g

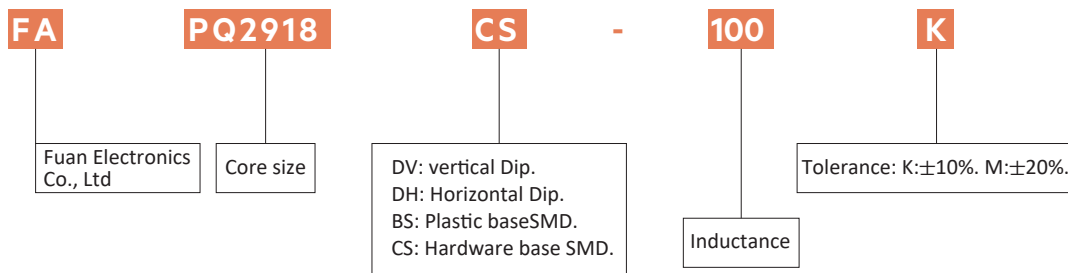

ELECTRICAL CHARACTERISTICS AT 25°C

Part Number	Ind.(uH)	D.C.Resistance (mΩ)		I _{last} (A)Typical Drop20%	I _{rms} (A)Typical: ^Δ t40°C	
		Typ	Max		5 minutes	30 minutes
FAPQ2918□-1R0M	1.0	0.72	0.87	120	60.0	50.0
FAPQ2918□-1R5M	1.5	0.72	0.87	104	60.0	50.0
FAPQ2918□-2R2M	2.2	0.72	0.87	76	60.0	50.0
FAPQ2918□-3R3M	3.3	0.72	0.87	52	60.0	50.0
FAPQ2918□-4R7M	4.7	2.60	2.86	65	28.0	26.0
FAPQ2918□-6R8M	6.8	2.60	2.86	45	28.0	26.0
FAPQ2918□-100K	10	2.60	2.86	34	28.0	26.0
FAPQ2918□-150K	15	3.10	3.35	22	22.0	20.0
FAPQ2918□-220K	22	3.10	3.35	19	22.0	20.0
FAPQ2918□-330K	33	3.10	3.35	13	22.0	20.0

TEST CONDITIONS:

- 1.All data is tested based on 25°C ambient temperature.
- 2.Inductance measure condition at 100KHz 0.1V.
- 3.Temperature rise current: the actual value of DC current when the temperature rise is T40°C(Ta=25°C).
- 4.Special remind: Circuit design,component planement,PWB size and thickness,cooling system and etc.all will affect the product temperature.Please verify the product temperure in the final application..

Product datasheet

ELECTRICAL INFORMATION

Dimension in mm

2918BS

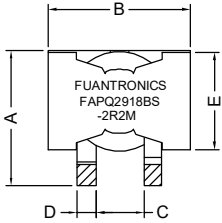

Top view

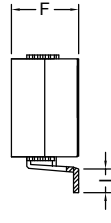

Side view

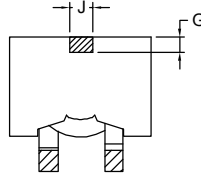

Bottom view

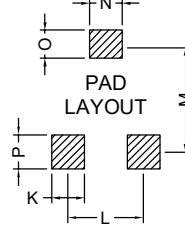

A	27.9 Max	J	5.00±0.20
B	27.9 Max	K	6.00 REF
C	6.60±0.60	L	10.4 REF
D	3.80±0.20	M	22.1 REF
E	19.7 Max	N	6.50 REF
F	19.0 Max	O	5.50 REF
G	4.50 REF	P	6.00 REF
I	3.80 Min		

2918CS

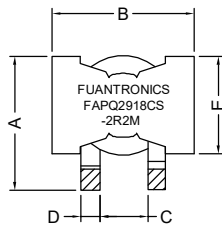

Top view

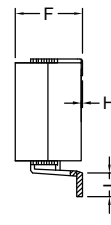

Side view

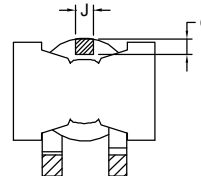

Bottom view

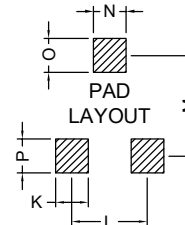

A	27.9 Max	I	3.80 Min
B	27.9 Max	J	3.00±0.20
C	6.60±0.60	K	6.00 REF
D	3.80±0.20	L	10.4 REF
E	19.7 Max	M	22.75 REF
F	18.5 Max	N	6.00 REF
G	2.50 REF	O	5.50 REF
H	0-0.15	P	6.00 REF

2918DV

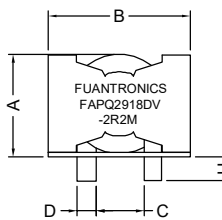

Top view

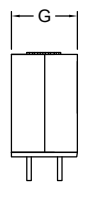

Side view

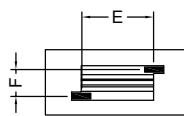

Bottom view

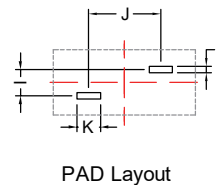

A	27.9 Max	I	7.00 REF
B	27.9 Max	J	10.4 REF
C	6.60±0.60	K	5.00 REF
D	3.80±0.20	L	1.50 REF
E	10.4±0.50		
F	7.00±0.50		
G	18.5 Max		
H	3.50±0.50		

2918DH-P1

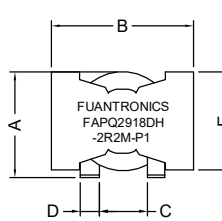

Top view

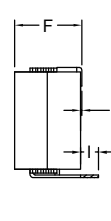

Side view

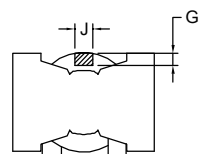

Bottom view

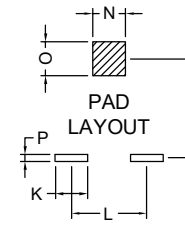

A	27.9 Max	I	3.00±0.50
B	27.9 Max	J	3.00±0.20
C	6.60±0.60	K	6.00 REF
D	3.80±0.20	L	10.4 REF
E	19.7 Max	M	19.75 REF
F	18.5 Max	N	6.00 REF
G	2.50 REF	O	5.50 REF
H	0-0.15	P	1.50 REF

2918DH-P2

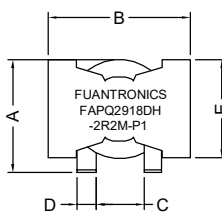

Top view

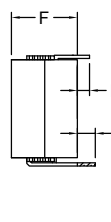

Side view

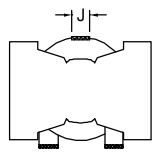

Bottom view

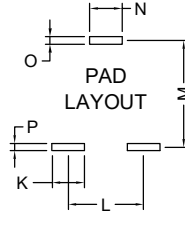

A	27.9 Max	I	3.50±0.50
B	27.9 Max	J	3.00±0.20
C	6.60±0.60	K	5.00 REF
D	3.80±0.20	L	9.50 REF
E	19.7 Max	M	20.0 REF
F	18.5 Max	N	4.00 REF
G	2.50 REF	O	1.00 REF
H	3.00±0.50	P	1.50 REF

CURRENT VS TEMPERATURE RISE

(Temperature rise current is 30 minutes)

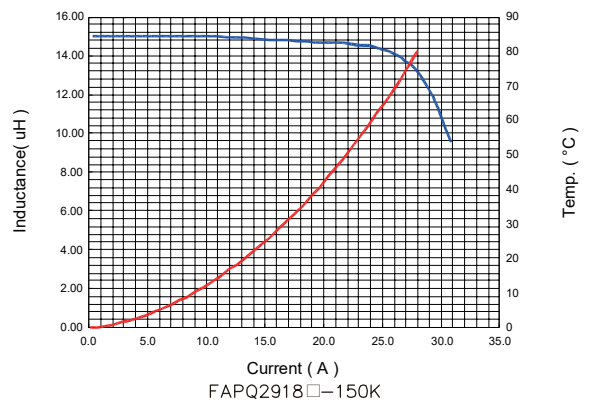
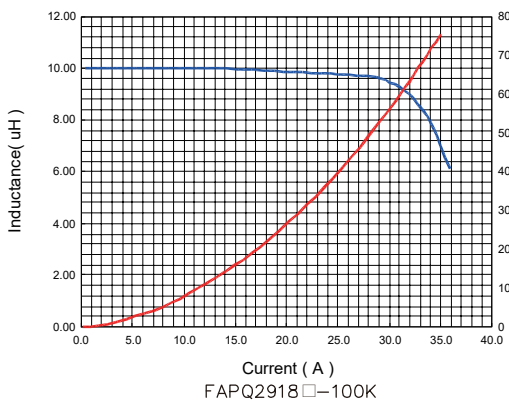
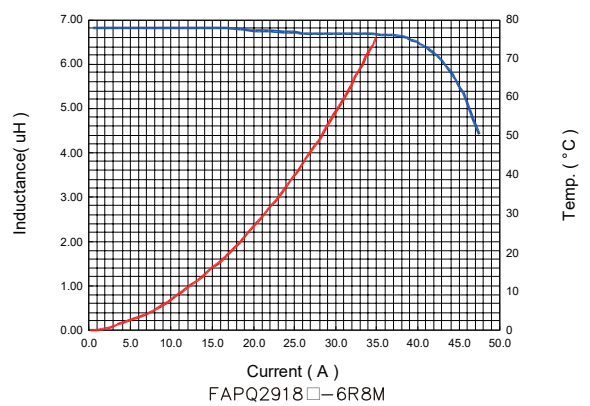
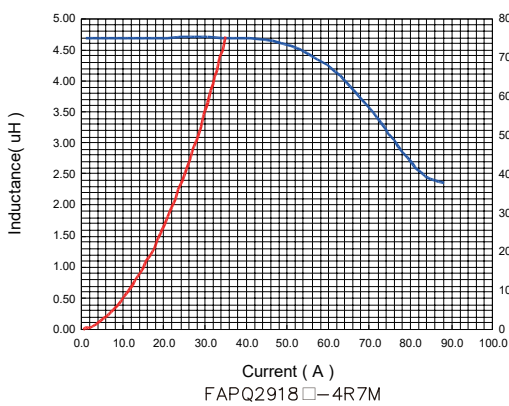
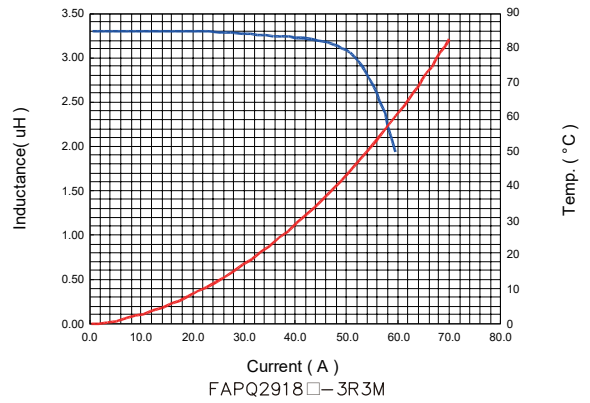
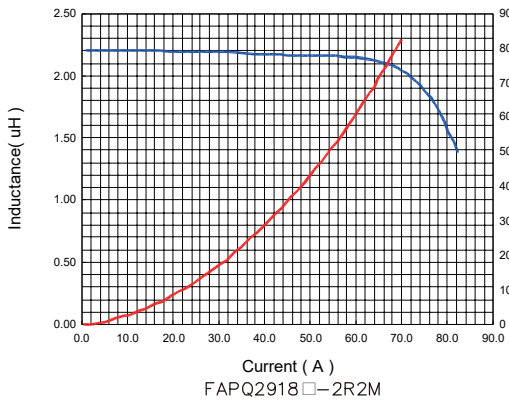
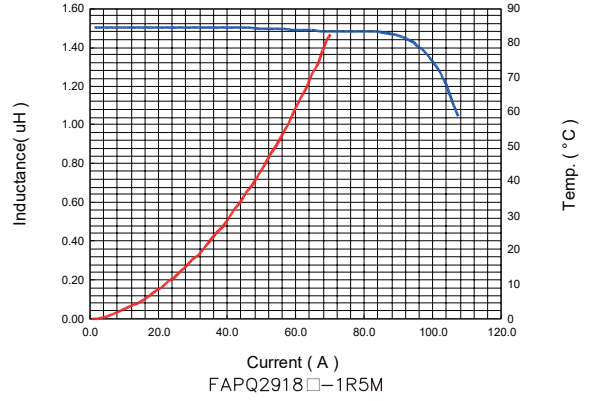
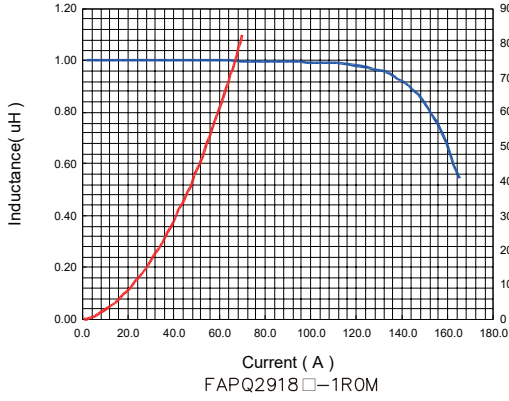

Product datasheet

CURRENT VS TEMPERATURE RISE

(Temperature rise current is 30 minutes)

