

**Dimensions: (UNIT:mm)**

A	15.9 ± 0.3
B	10.0 ± 0.25
C	5.9 ± 0.2
D	6.3 ± 0.25
E	6.8 Min
F	
G	
H	

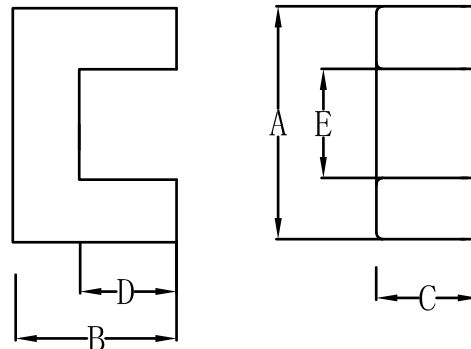

**Test conditions**

AL: F=10KHz U=0.1V N=10Ts

**Effective parameter**

C1(mm) <sup>-1</sup>	Ae(mm <sup>2</sup> )	Le(mm)	Ve(mm <sup>3</sup> )	Weight(g)
1.98	26.0	51.3	1330	≈3.4

**Core halves**

AL measured in combination with a non-gapped core half, clamping force for Al measurements, 60+/-20N unless otherwise stated.

Grade	AL (nH)	μe	AIR GAP μm	Type number
P3	1000 ± 25%	≈0	≈0	UF15.7-P3
P4	1000 ± 25%	≈0	≈0	UF15.7-P4

**Properties of core sets under power conditions**

Grade	B (mT)at H=250 A/m F=25KHz T=100°C	Core loss (w) at			
		F=25 KHz B̂=200mT T=100°C	f=100 KHz B̂=100mT T=100°C	F=100 KHz B̂=200mT T=100°C	F=400 KHz B̂=50mT T=100°C
P3	≥320	-	-	-	-
P4	≥320	-	-	-	-

**Core sets of high permeability grades.**

Clamping force for Al measurements, 10+/-5N

Grade	AL(nH)	μe	AIR GAP μm	Type number
H5K	2000±25%	≈0	≈0	UF15.7-H5K
H7K	3000±25%	≈0	≈0	UF15.7-H7K
H10K	3500±30%	≈0	≈0	UF15.7-H10K
H12K	4500±30%	≈0	≈0	UF15.7-H12K

**Properties of core sets under power conditions (continued)**

Grade	B (mT)at H=250 A/m F=25KHz T=100°C	Core loss (w) at			
		F=500 KHz B̂=50mT T=100°C	F=500 KHz B̂=100mT T=100°C	F=1.0 MHz B̂=30mT T=100°C	F=1.0 MHz B̂=50mT T=100°C
P3	≥320	-	-	-	-
P4	≥320	-	-	-	-

**Note:**

- 1: Document is the property of FUAN Inc & is not allowed to be duplicated without authorization
- 2: RoHS compliant.