

SPECIFICATION FOR APPROVAL

Material

| | |
|----------------------------|--------------------------------|
| Production: | Iron Powder Cores |
| FUAN.P/N: | KT130-52 |
| AL: | 79.0(nH/N ²)(±10%) |
| Material: | -52 |
| Coating Color: | Green/Blue |
| Coating material: | epoxy |
| Coating Breakdown Voltage: | 600V, 0.5mA, 2Sec |

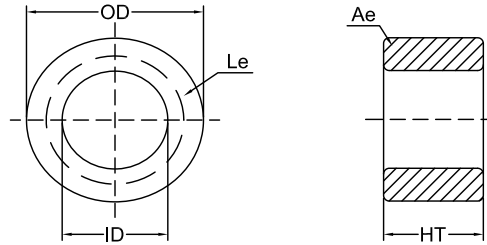

Physical Characteristics

| After Coating | | | Le(cm) | Ae(cm ²) | V(cm ³) | W(cm ²) | Weight (g) (ref.) | Box Quantity (Pieces) |
|---------------|-----------|-----------|--------|----------------------|---------------------|---------------------|-------------------|-----------------------|
| OD mm | ID mm | Ht mm | | | | | | |
| 33.0±0.50 | 19.8±0.50 | 11.1±0.63 | 8.280 | 0.698 | 5.780 | 0.967 | 41.27 | 336 |

Electrical Parameters(Typical) Temperature(25°C±2°C)

| Test Item | Test Condition | Value(Typical) | Test Instrument |
|------------|--|-----------------------------|-----------------|
| Inductance | φ0.29mm/10Ts, 10kHz/1V, I=0A (Evenly full windings) | 7.9μH(±10%) | CH3302 |
| DC-Bias | φ0.50mm/55Ts,10kHz/1V,L(6.0A)/L(0A)*100%(H=50Oe) (Evenly full windings) | 53%(Min.) | WK3255B+WK3265B |
| Core Loss | 100KHz/140Gs | 67mW/cm ³ (Max.) | SY-8219 |
| Q | φ0.50mm/55Ts, 200kHz/1V, I=0A (Evenly full windings) | 16.0(Min.) | CH3302 |
| Remarks | Set the internal resistance of LCR meter to 100Ω. | | |

DC-Bias Curves(Typical)

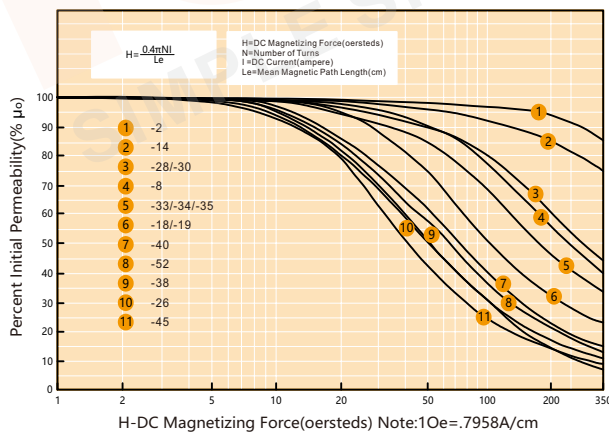

Core Loss Curves(Typical)

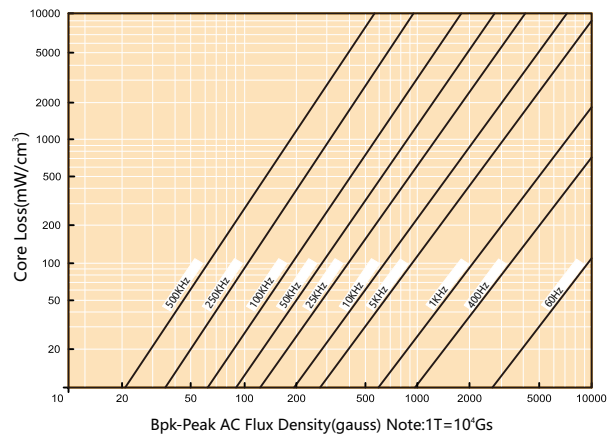

Iron Powder Cores is a magnetic core which use traditional production arts, after the pure powder which content of Fe is more than 99% surface insulation coating and then mixed pressed with organic binder. Because it hasn't been conducted in the high temperature, so it's used temperature is -65C ~ +125C. Products including permeability 10ui-100ui, toroid, E type,