

INTERNATIONAL PC PLUG-IN POWER TRANSFORMERS



All parts meet RoHS compliance.

FEATURES

- Power – 2.5VA to 56VA
- PC board plug-in mounting
- Dual bobbin; double reinforced insulation
- High (4000V) isolation
- Vacuum impregnated
- Primaries : Dual primaries [115/230V - 50/60Hz]
- Secondaries can be series or parallel connected

PHYSICAL CHARACTERISTICS

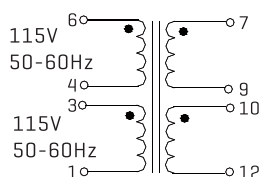
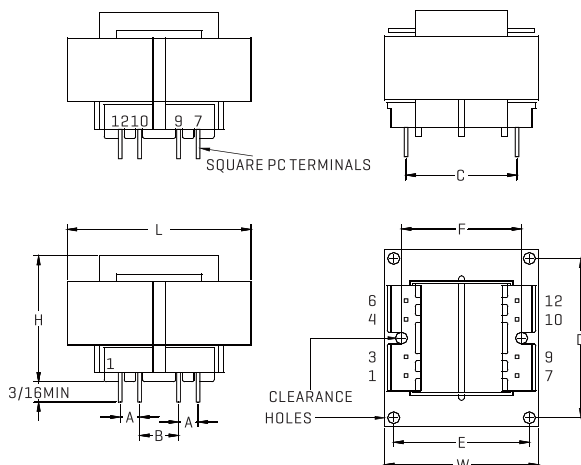

ELECTRICAL CHARACTERISTICS AT 25°C

Part Number	VA	Secondary RMS Rating	
		Series	Parallel
FAPT-2.5-10	2.5	10V C.T. @ 0.25A	10V C.T. @ 0.25A
FAPT-5.0-10	5.0	10V C.T. @ 0.5A	10V C.T. @ 0.5A
FAPT-10-10	10	10V C.T. @ 1.0A	10V C.T. @ 1.0A
FAPT-20-10	20	10V C.T. @ 2.0A	10V C.T. @ 2.0A
FAPT-30-10	30	10V C.T. @ 3.0A	10V C.T. @ 3.0A
FAPT-56-10	56	10V C.T. @ 5.6A	10V C.T. @ 5.6A
FAPT-2.5-12	2.5	12.6V C.T. @ 0.2A	12.6V C.T. @ 0.2A
FAPT-5.0-12	5.0	12.6V C.T. @ 0.4A	12.6V C.T. @ 0.4A
FAPT-10-12	10	12.6V C.T. @ 0.8A	12.6V C.T. @ 0.8A
FAPT-20-12	20	12.6V C.T. @ 1.6A	12.6V C.T. @ 1.6A
FAPT-30-12	30	12.6V C.T. @ 2.4A	12.6V C.T. @ 2.4A
FAPT-56-12	56	12.6V C.T. @ 4.4A	12.6V C.T. @ 4.4A
FAPT-2.5-16	2.5	16V C.T. @ 0.15A	16V C.T. @ 0.15A
FAPT-5.0-16	5.0	16V C.T. @ 0.31A	16V C.T. @ 0.31A
FAPT-10-16	10	16V C.T. @ 0.62A	16V C.T. @ 0.62A
FAPT-20-16	20	16V C.T. @ 1.25A	16V C.T. @ 1.25A
FAPT-30-16	30	16V C.T. @ 1.9A	16V C.T. @ 1.9A
FAPT-56-16	56	16V C.T. @ 3.5A	16V C.T. @ 3.5A
FAPT-2.5-20	2.5	20V C.T. @ 0.12A	20V C.T. @ 0.12A
FAPT-5.0-20	5.0	20V C.T. @ 0.25A	20V C.T. @ 0.25A
FAPT-10-20	10	20V C.T. @ 0.5A	20V C.T. @ 0.5A
FAPT-20-20	20	20V C.T. @ 1.0A	20V C.T. @ 1.0A
FAPT-30-20	30	20V C.T. @ 1.5A	20V C.T. @ 1.5A
FAPT-56-20	56	20V C.T. @ 2.8A	20V C.T. @ 2.8A
FAPT-2.5-24	2.5	24V C.T. @ 0.1A	24V C.T. @ 0.1A
FAPT-5.0-24	5.0	24V C.T. @ 0.21A	24V C.T. @ 0.21A
FAPT-10-24	10	24V C.T. @ 0.42A	24V C.T. @ 0.42A
FAPT-20-24	20	24V C.T. @ 0.83A	24V C.T. @ 0.83A
FAPT-30-24	30	24V C.T. @ 1.25A	24V C.T. @ 1.25A
FAPT-56-24	56	24V C.T. @ 2.33A	24V C.T. @ 2.33A
FAPT-2.5-28	2.5	28V C.T. @ 0.09A	28V C.T. @ 0.09A
FAPT-5.0-28	5.0	28V C.T. @ 0.18A	28V C.T. @ 0.18A
FAPT-10-28	10	28V C.T. @ 0.36A	28V C.T. @ 0.36A
FAPT-20-28	20	28V C.T. @ 0.72A	28V C.T. @ 0.72A
FAPT-30-28	30	28V C.T. @ 1.06A	28V C.T. @ 1.06A
FAPT-56-28	56	28V C.T. @ 2.0A	28V C.T. @ 2.0A
FAPT-2.5-36	2.5	36V C.T. @ 0.07A	36V C.T. @ 0.07A
FAPT-5.0-36	5.0	36V C.T. @ 0.14A	36V C.T. @ 0.14A
FAPT-10-36	10	36V C.T. @ 0.28A	36V C.T. @ 0.28A
FAPT-20-36	20	36V C.T. @ 0.56A	36V C.T. @ 0.56A
FAPT-30-36	30	36V C.T. @ 0.82A	36V C.T. @ 0.82A
FAPT-56-36	56	36V C.T. @ 1.56A	36V C.T. @ 1.56A

VA	Dimensions					
	L	W	H	A	B	C
2.5	41.3	33.3	28.6	5.08	6.35	24.4
5.0	41.3	33.3	34.9	5.08	10.2	25.4
10	47.6	39.7	34.9	5.08	10.2	29.0
20	57.2	47.6	41.3	10.2	10.2	37.1
30	66.7	55.5	39.7	14.0	6.99	42.7
56	76.2	63.5	46	15.2	7.62	48.3
VA	D	E	F	PIN DIM	MTG	Wgt
2.5	---	---	27.0	SQ0.64	#4	113g
5.0	---	---	27.0	SQ0.64	#4	167g
10	---	---	31.8	SQ0.97	#4	240g
20	---	---	38.1	SQ0.97	#4	407g
30	55.4	44.5	---	SQ1.14	#6	520g
56	63.5	50.8	---	SQ1.14	#6	770g

ALL DIMENSIONS IN MM